



Kitchen Mixer Taps



ALVEUS
... from Slovenia



ALVEUS kitchen mixer taps



The kitchen sink alone will not do much, but together with the mixer tap, it can do some cleaning wonders. You can choose the first kitchen mixer tap you see or you can dive into deep waters and make a study out of it. You may consider the design, the colour, its functionality...

Design

Size

Functionality

Colour

Pull-out spout

Handle on top

Shower function

Semi profi



For cleaning the Alveus kitchen mixer taps it is best to use a soft cloth, hot water, and liquid detergent for kitchen sinks. Should scale build-up on the tap, remove it with 9 % acetic acid. Silver cleaners, steel wool pads, bleach, or abrasive detergents can damage the tap finish, so they should be avoided. Chlorine detergents (soda hypochlorite) or hydrochloric acid can have a similar effect.

Alveus kitchen mixer taps are **technologically sophisticated** and come in **various shapes** to complement traditional as well as trendy kitchens.

The numerous varieties with regard to installation, operation and surface finishes allow an abundance of combinations.

- Taps are made of brass or stainless steel with surface finish **polished chrome (CHR)**, **brushed chrome (CHR-BR)**, **Satin finish (SAT)**, Alveus **colour range** and ceramic nitride (**PVD-treatment**) in four shiny colours (Gold, Copper, Anthracite and Bronze)
- Ceramic discs and metal handles ensure reliable operation and long service life
- Taps can operate with **water pressure from 0,5 to 8 bar** (recommended 1 to 5 bar)
- Several models are fitted with **pull-out spout** and **spray function**
- Taps can be installed on the sink or kitchen worktop
- Some models are convenient for **under-window installation**
- Two flexible hoses with 3/8" connections ensure simple and fast installation to dual (hot-cold) water supply system
- Model Cleo - PS is equipped with three connection hoses and can operate only with cold water supply, delivering hot water instantaneously on demand by means of un-pressurised water heater (usually electric boiler)



ALVEUS

Do not forget to hydrate ... with clean water

Monarch collection

Sink mixer Aquila is designed to be **connected to the water filter**, through which water can be cleaned of all contaminants, which impair the quality and taste of drinking water.

Two functional levers make access simple and easy. With the right lever, Aqualia allows using cold and hot water, for ordinary home use, with the left lever you can have fresh, pure to drink, water.

As there are two separated inlet hoses there are also two separated inlet hoses for normal, unfiltered water and another for filtered, drinking water.

Sink mixers do not include the water filter.

Sink mixer Aquila can be connected to water filter designed for household water purification.

A premium Monarch mixer tap collection is available in four shiny colour shades - **GOLD, COPPER, ANTHRACITE**, and **BRONZE**. Add an extra touch of elegance and luster into your kitchen with a hint of metal shine in combination with gold, classic inox, or composite kitchen sink.



About 70% of the body is made up of water
[blood = 93% | muscle = 73% | body fat = 10%]

Recommended water intake
(per day) 1,6 l for women
2 l for men.



Black is always IN



You can never go wrong with black, also when choosing a kitchen mixer tap. Mat black kitchen mixer tap in combination with some other or all elements in the kitchen will give your kitchen an industrial look. Dare to combine black with some gold elements and you will uplift your kitchen to an elegant chic room.



Lyra - S



Elia



Arc 80



Eden



Nerina



Nerina

Fancy any other colour?

You can combine the colour of the mixer tap with a kitchen sink, with the kitchen cabinets, maybe with a cabinet knobs, or just go against all "rules" and make a kitchen mixer tap to stand out in its unique colour.



Arc 110



Elza



Santo



Roxa



Delos-P



Cleo



Zenit



Zina



Siros-P



Selma



Elza



Semi PROFI kitchen mixer tap



Do you enjoy yourself in the kitchen? Really enjoy? **Do you almost feel like a chef?** Then you should consider choosing a mixer tap appropriate to your needs - a semi-professional one. A mixer tap big and flexible enough that allows you easy handling around the kitchen sink with all the pots and pans.



Lyra - S

Billy - S

Elia

Romi-P



Cleo - P

Azeta - P

Siros - P

Vela - P

Delos - P

Arc 20 - P

Romi - P

Are you looking for more than just design in the kitchen mixer tap? You would like to get closer to the bowl of salad, to give it a nice shower or maybe both? Look for the Alveus kitchen mixer tap models with a mark P, S or PS in the title.

- P** - pull out spout
- S** - shower function
- PS** - pull out and shower function

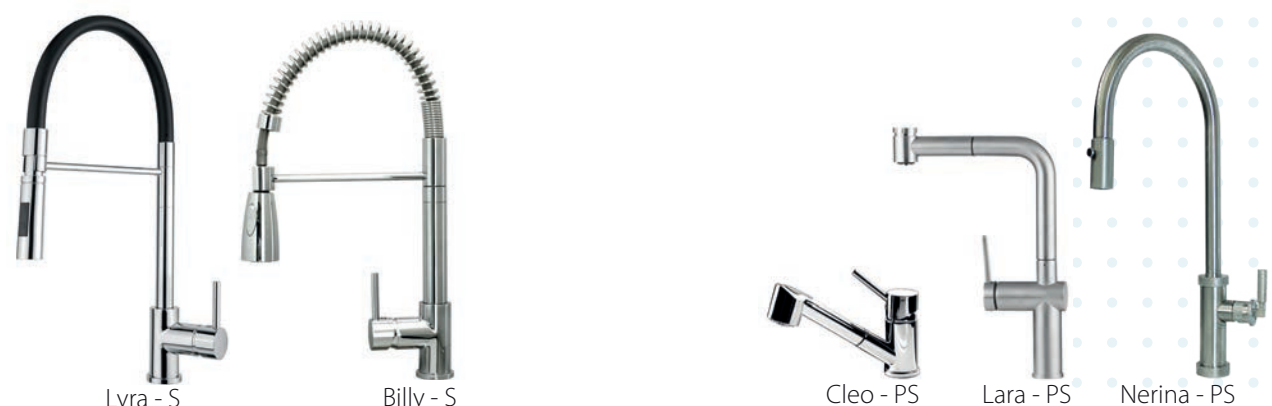

Lyra - S

Billy - S

Cleo - PS

Lara - PS

Nerina - PS



ALVEUS

The handle on top



Do you remember what a challenge it is when you are baking, your hands and fingers are covered in dough, and you really need to get some water or wash those hands? That “mission impossible” to reach the handle! At Alveus we thought also of such ventures.
A kitchen mixer tap with a handle on the top of it is an ideal solution.
Quick and easy access to the handle!



Zina



Zenit



Cleo - PS

Cleo - P



Cleo

Admiring nature while washing the dishes

More and more kitchens are designed with a view from behind the kitchen sink so that while washing dishes or preparing food, you can admire the beautifully growing plants in the garden or watch the children playing on the lawn.
The kitchen mixer tap would normally stand in the way for you to fully open the window. With the **foldable Columba** or **submersible Norma**, you will easily open a window to water the plants, clean a window, or simply let fresh air into a room.



Norma



Columba

ALVEUS



Zina



Norma



Laguna Monarch

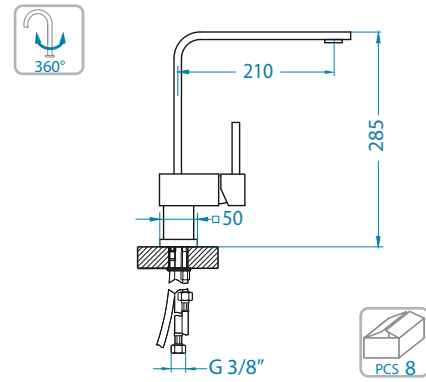

Slim Monarch

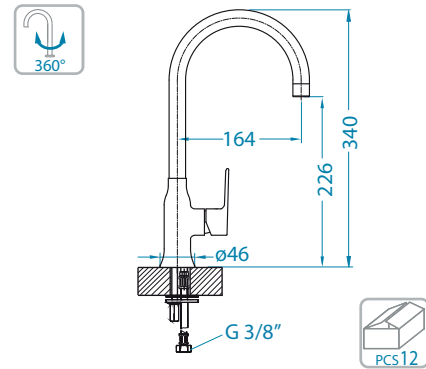

Fluid Monarch

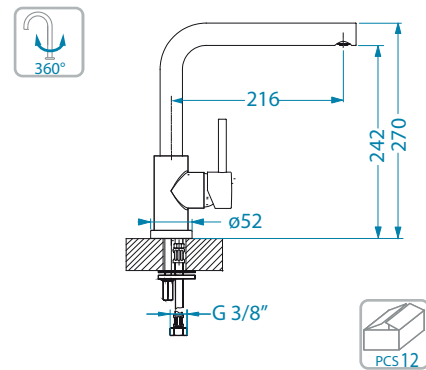

Oz Monarch

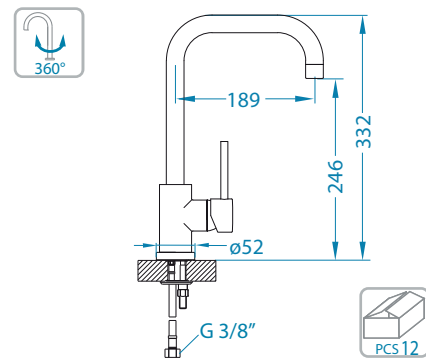

Aquila



Choice



Lara - PS



Azeta - P



Lago

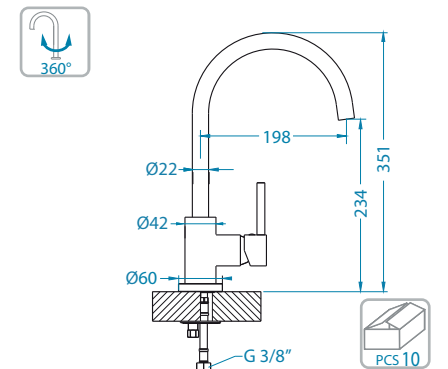
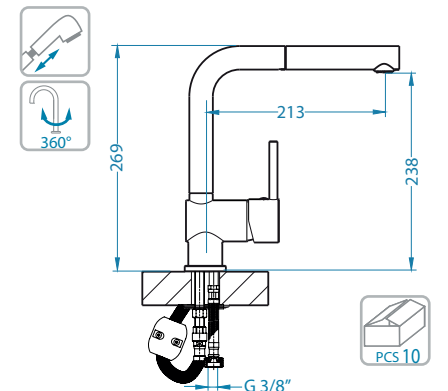
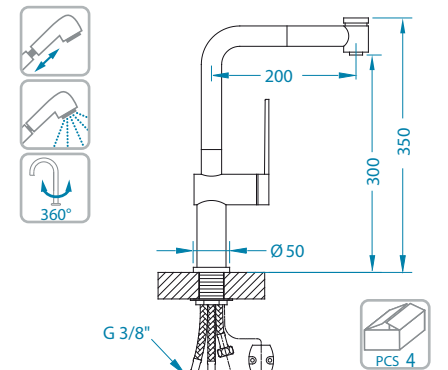
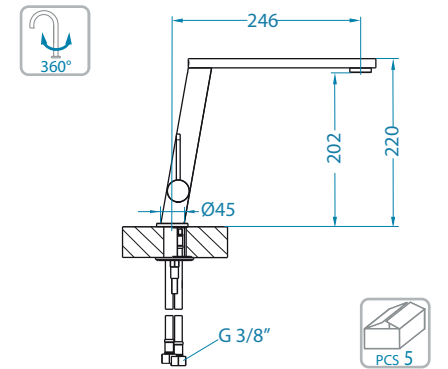
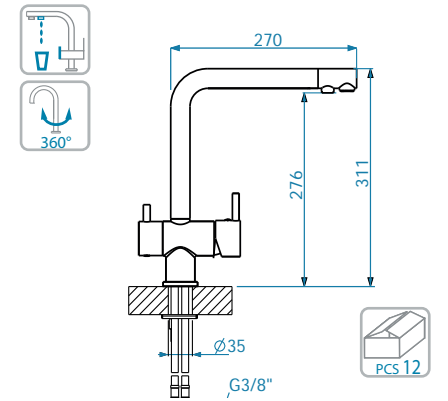

SAT
CHR - polished chrome
CHR-BR - brushed chrome



Pull out
spout



Shower
function



Under
window
model



For un-pressured
electric boiler



ALVEUS

Laguna



1088536 CHR

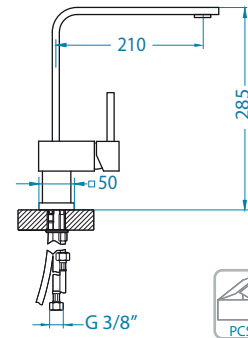

Cleo - P



1088776 CHR

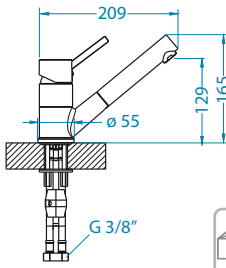

Cleo - PS



1088774 CHR



1088775 CHR

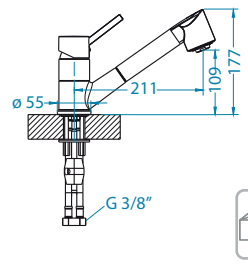

Arc 80



1128933 white



1128934 black

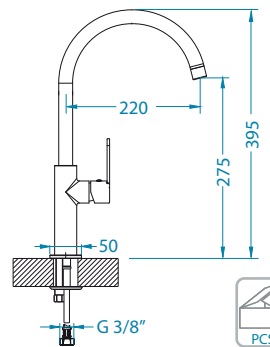

Pixy



1132175 CHR

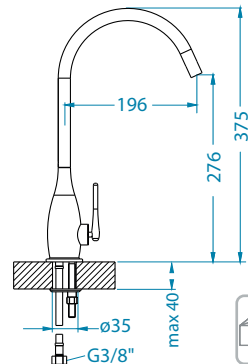

Romi - P



1132176 CHR

Nerina - PS



1132177 CHR



132178 CHR-BR



1132179 black

Oz



1097968 CHR

Quadra



1126719 CHR

Columba



1132181 CHR

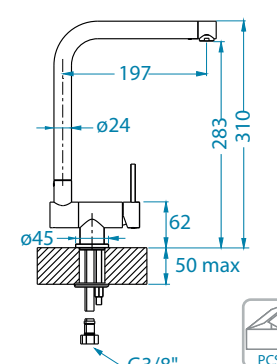
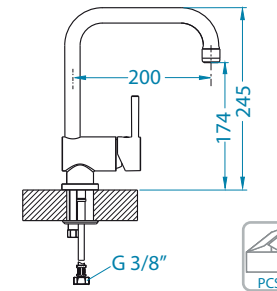
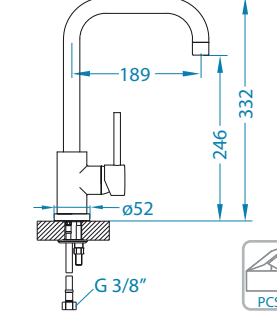
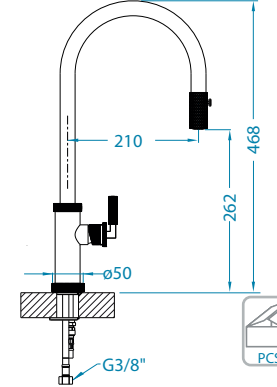
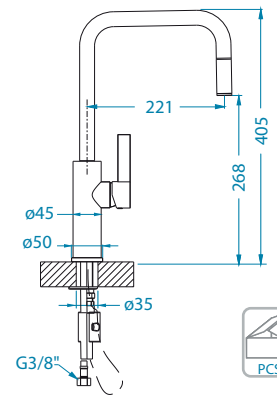

SAT - satin finish
CHR - polished chrome
CHR-BR - brushed chrome



Pull out spout



Shower function



Under window model



For un-pressured electric boiler



ALVEUS

Zina



1129057 CHR

1129058 G11

1129060 G04M

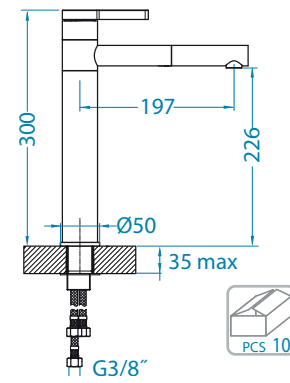

Siros - P



1129047 CHR

1129046 G11

1129044 G81

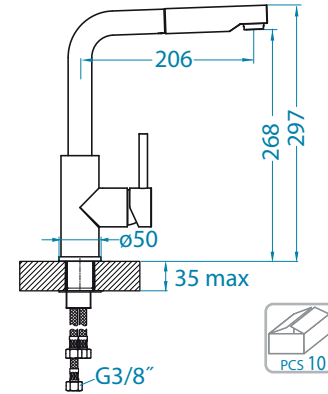

Selma



1129042 G55

1129043 G91

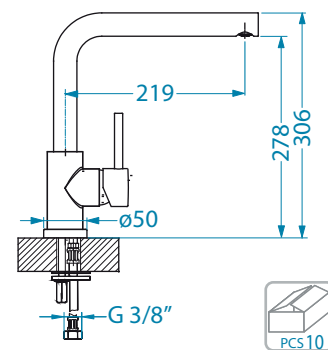

Zenit



1119872 CHR

1119873 G11

1123573 G81

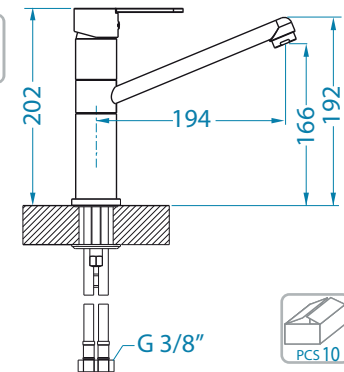

Cleo



1107682 G11

1107683 G02M

1107687 G05M

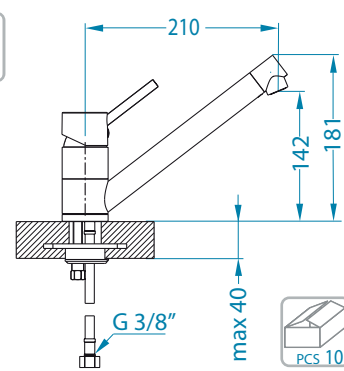

Delos - P



1129021 CHR

1129023 SAT

1129020 G55

1129019 G81

1129022 G91

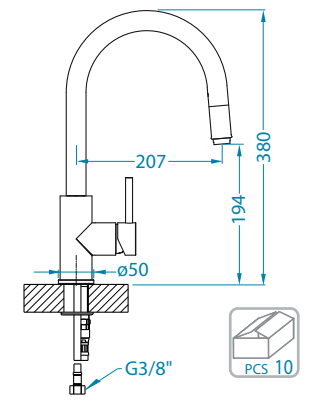

Elza



1129028 CHR

1129025 G11

1129029 G04M

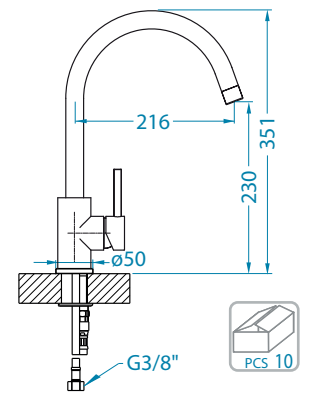

Santo



1129040 G55

1129041 G91

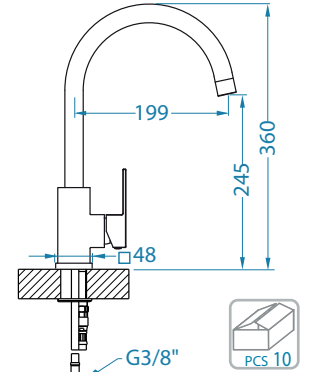

Tap brace - for additional reinforcement

ALLFIX -A

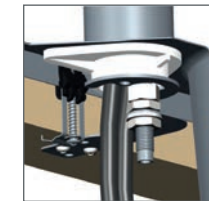

1115914

Oz



Arc 110

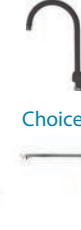

Quadra



Billy - S



Eden



Slim



ALLFIX -B

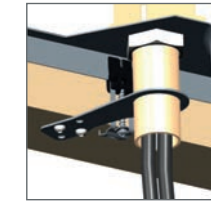

1115505

Norma



Lara - PS



Arc 80



Laguna



1078290

Angular valve with filter

Valve with filter is an additional obligatory* plumbing part for adjustment of water flow rate and protection of tap cartridge against damages caused by impurities or foreign parts.

*Condition for enforcement of warranty claims

SAT
CHR - satin finish
CHR-BR - polished chrome
CHR-BR - brushed chrome



Pull out
spout



Shower
function



Under
window
model



For un-pressured
electric boiler



ALVEUS



www.alveus.si, info@alveus.si
 Kovinoplastika Lož d.o.o., Lož, Cesta 19. oktobra 57, SI-1386 Stari trg pri Ložu, Slovenia
 Tel.: +386 1 70 95 100, Fax: +386 1 70 58 466
www.kovinoplastika.si, info@kovinoplastika.si

